

I.F.T.EX. Kenya 2012

Wednesday March 21 - Friday March 23

OSHWAL CENTRE (WESTLANDS)

NAIROBI - KENYA

Total exhibition area 3,891.83 m²

Update: Wednesday August 24, 2011 5:52 p.m.

This floorplan may be subject to changes!



I.F.T.EX. Kenya 2012

Wednesday March 21 - Friday March 23

OSHWAL CENTRE (WESTLANDS)

NAIROBI - KENYA

Hall B (Sumaria Court)

Hall A (KD Hall)



Total exhibition area 3,891.83 m²
Update: Wednesday August 24, 2011 5:52 p.m.
This floorplan may be subject to changes!

- Available Stand Space
- Reserved Stand Space
- Booked Stand Space

Updates are available daily on the web site: www.iftex.org

Main Entrance

Emergency Exit

Emergency Exit

Emergency Exit

I.F.T.EX. Kenya 2012

Wednesday March 21 - Friday March 23

OSHWAL CENTRE (WESTLANDS)

NAIROBI - KENYA

Hall C (Karanja Hall)

9 m ² Kenya Flower Grower	9 m ² Kenya Flower Grower	9 m ² Kenya Flower Grower	9 m ² Kenya Flower Grower	9 m ² Kenya Flower Grower	9 m ² Kenya Flower Grower	9 m ² Kenya Flower Grower	9 m ² Kenya Flower Grower	9 m ² Kenya Flower Grower	9 m ² Kenya Flower Grower	9 m ² Kenya Flower Grower
C.123	C.124	C.212	C.323	C.324	C.412	C.523	C.524	C.612	C.623	

Hall D (Chandrami Hall)

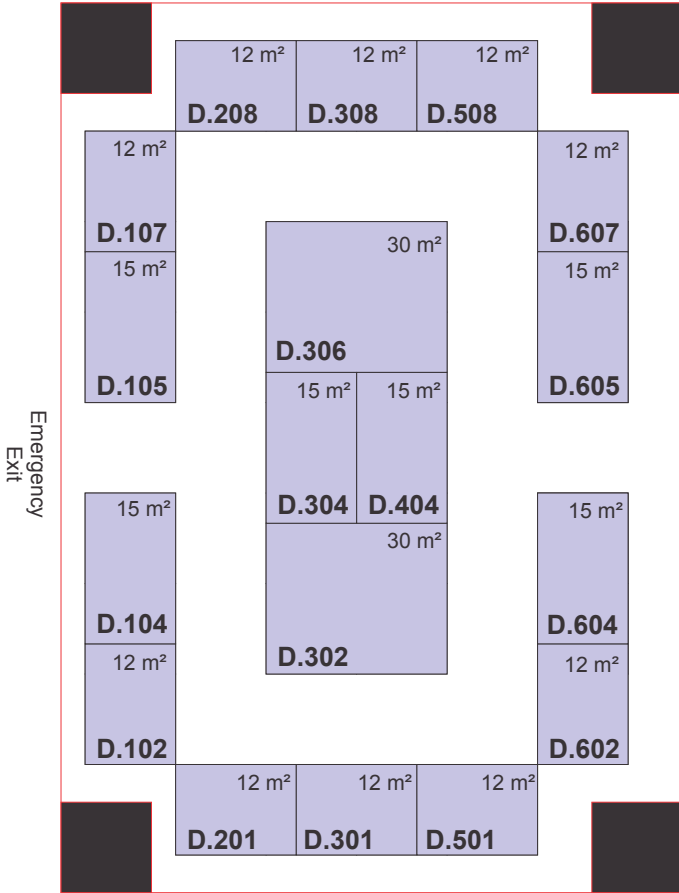

Total exhibition area 3,891.83 m²
 Update: Wednesday August 24, 2011 5:52 p.m.
 This floorplan may be subject to changes!

- Available Stand Space
- Reserved Stand Space
- Booked Stand Space

Emergency Exit

Updates are available daily on the web site: www.iftex.org